

SEAHORSE QUENDA

TUG



OVERVIEW

Versatile all round tug . Ideal economical option for extended ocean tows or shallow draft Project scopes. RTK GPS Ready.Has OVID history.

PRINCIPAL PARTICULARS

Length overall	23.50m	Operational fuel burn	110lt/hr @ 8 Knots
Width	7.32m	Max speed	12Kn sprint
Bollard pull	C Class	Range (25% reserve)	4000Nm
Main engines	Cat 3412	Total power	1450hp
Operating draft	2.40m	Maximum draft	2.80m
Fuel capacity	76m3	FW capacity	13.94m3

SURVEY

Registry	AMSA	Max Crew	5 crew, 10 special pax
Class	2B	Official# / UVI	451986

DECK EQUIPMENT

Tow hook	25t SWL	Recovery winch	10t
----------	---------	----------------	-----

ACCOMMODATION

Berths	1 x dbl, 1 x sgl, 4 x dbl bunks	Features	Air conditioned
--------	---------------------------------	----------	-----------------

SEAHORSE QUENDA

TUG



GENERAL ARRANGEMENT

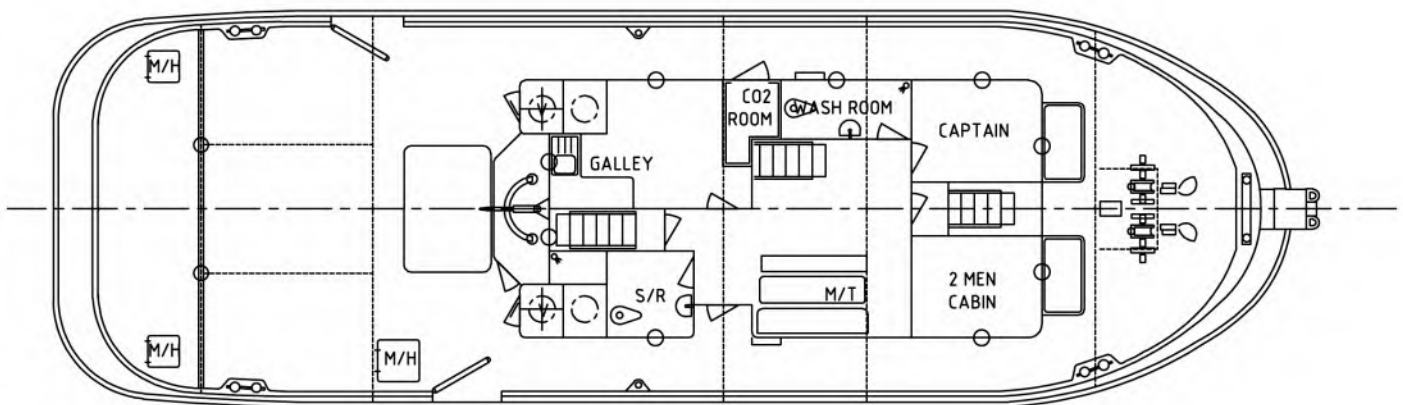
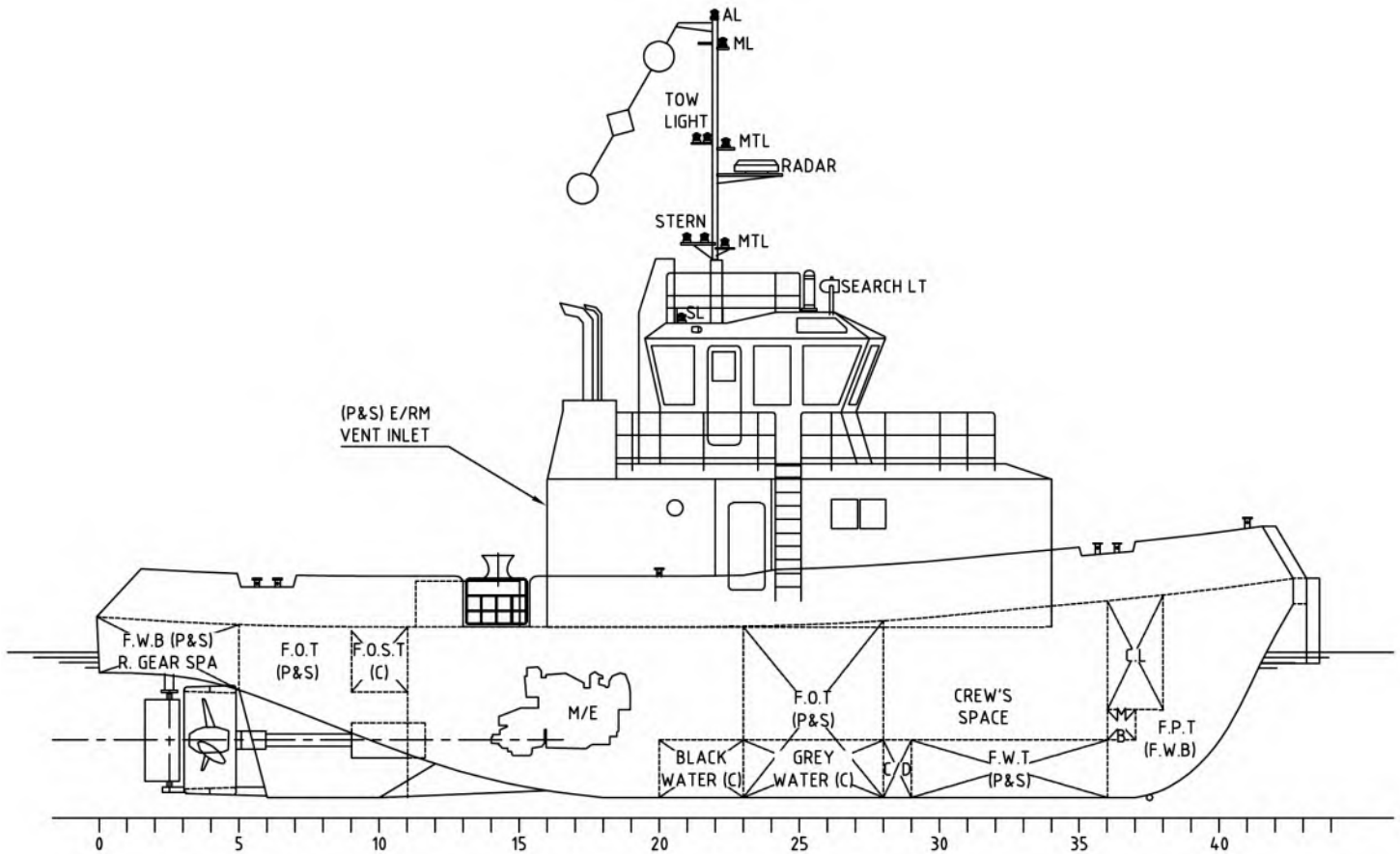

The data on this specification sheet has been published in good faith and should be considered for general information purposes only. It does not warrant its accuracy or completeness and to the full extent allowed by law excludes liability.